

NDB2Z Miniature Circuit Breakers Nader

1. Product Overview

			
Product models	NDB2Z-63	NDB2Z-63 (PV)	NDB2ZB-40
Rated operational voltage (V)	DC250V(1P)/DC500V(2P)	DC750V(3P)/DC1000V(4P)	DC250V
Rated operating current (A)	1 ~ 63A	1 ~ 63A	10 ~ 40A
Number of poles	1P、2P	3P、4P	1PN
Product certification	CCC		

2. Product Features

● Scope of application and purpose

NDB2Z series circuit breakers are applicable to low-voltage terminal power distribution in such fields as industry, civil construction, energy, communication and infrastructure.

● Design features

- ◆ Quick closure: ensures reliable operation of impact load and prolongs the service life of circuit breaker
- ◆ Frame wiring structure: Reliable wiring
- ◆ Supporting a variety of accessories: Simple and convenient function extension
- ◆ Modulization and modularization: Arbitrary combination

● Structural features

- ◆ NDB2-63 External structural drawing

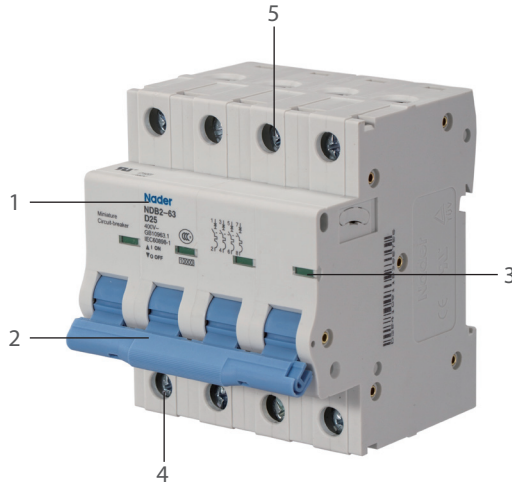

1. Product model
2. Handle
3. Closing indication
4. Outgoing line terminal
5. Incoming line terminal

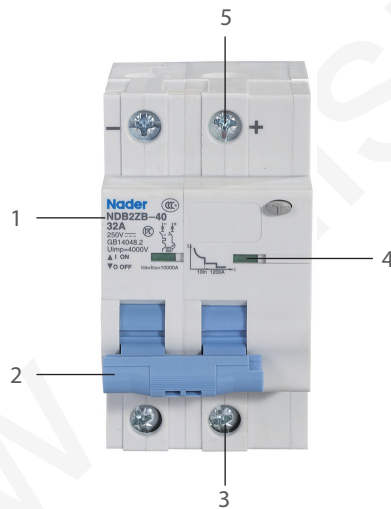

1. Product model
2. Handle
3. Outgoing line terminal
4. Closing indication
5. Incoming line terminal

● Meeting the following standards

- ◆ GB14048.2 Low-voltage switchgear and controlgear - Part 2: Circuit breaker.
- ◆ IEC 60947-2 Low-voltage switchgear and controlgear-Part 2.

3. Application scope

● Electrical symbols



● Applicable environment

- ◆ Temperature of the working environment/storage temperature

Use temperature: $-35^{\circ}\text{C}\sim+70^{\circ}\text{C}$, the average value in 24h is not more than $+35^{\circ}\text{C}$

Storage temperature: $-35^{\circ}\text{C}\sim+70^{\circ}\text{C}$

- ◆ Altitude

Installation site altitude $\leq 2,000\text{m}$.

- ◆ Relative humidity for operation/Relative humidity for storage

The relative humidity of atmosphere is not more than 50% at the ambient air temperature of $+40^{\circ}\text{C}$; at a lower temperature, a higher relative humidity is allowed, for example, 90% at 20°C . Special measures should be taken to deal with occasional condensation due to temperature change.

● Pollution grade

- ◆ 3 poles

● Protection grade

- ◆ Product protection grade: IP20

● Installation category

- ◆ II Class II (load level) and Class III (power distribution and control level)

● Installation way

- ◆ Installed on the TH35mm \times 7.5 standard guard rail

● Installation direction

- ◆ Vertical installation, with the gradient between the installation plane and the vertical plane $\leq \pm 5^{\circ}$
- ◆ Horizontal installation

● Environmental protection requirements

- ◆ Products meet the RoHS standard

4. Technical Characteristics of the Product

4.1 Description of Specifications and Models of NDB2Z-63

Serial No.	Serial No. name	Code explanation
1	Enterprise code	ND : Nader brand low-voltage apparatus
2	Model	B : Disconnecting switch
3	Design serial No.	2
4		Z : DC
5	Frame grade	63
6	Tripping characteristic	B、C
7	Rated current	1、1.2、1.5、1.6、2、3、4、5、6、7、8、10、12、13、15、16、20、25、30、32、35、40、50、60、63
8	Grade number	Conventional products: 1 : 1P、2 : 2P PV: 3 : 3P、4 : 4P
9	PV code	None: Conventional product PV: Indicates photovoltaic use

4.2 Description of Specifications and Models of NDB2ZB-40

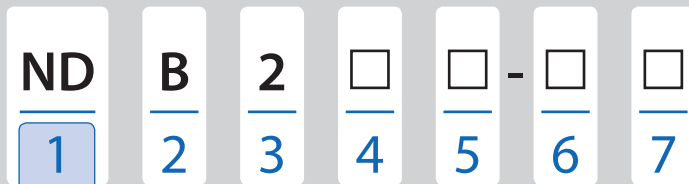

Serial No.	Serial No. name	Code explanation
1	Enterprise code	ND: Nader brand low-voltage apparatus
2	Model	B: Miniature Circuit Breakers
3	Design serial No.	2
4	DC	Z: DC
5	Function code	B: Three-section protection
6	Frame grade	40
7	Rated current	10、16、20、25、32、40

4.3 Technical Parameters

Specifications	NDB2Z-63	NDB2Z-63 (PV)	NDB2ZB-40
Rated operational voltage	DC250V(1P)/DC250V(2P)	DC750V(3P)/DC1000V(4P)	DC250V
Rated insulation voltage	1000V	1000V	1000V
Rated impulse withstand voltage	6kV	6kV	4kV
Rated current	1A、1.2A、1.5A、1.6A、2A、3A、4A、5A、6A、7A、8A、10A、12A、13A、15A、16A、20A、25A、30A、32A、40A、50A、63A、		10A、16A、20A、25A、32A、40A
Rated ultimate short-circuit breaking capacity	10kA	10kA	10kA
Rated running short-circuit breaking capacity	7.5kA	7.5kA	10kA
Instantaneous tripping characteristic	B: $6I_n \pm 20\%$ C: $12I_n \pm 20\%$	B: $6I_n \pm 20\%$ C: $12I_n \pm 20\%$	8In: No tripping within 200ms 10In: Tripping within 10~30ms 1680A: Tripping within 6ms
Number of poles	1P/2P	3P/4P	1PN
Mechanical life	20000	20000	10000

4.4 Tripping Characteristic Curve

● NDB2Z-63/NDB2Z-63 (PV)

Type B 6 In (1 ± 20%)

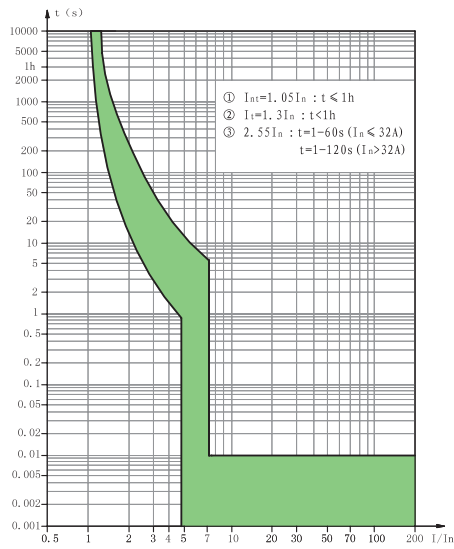

Type C 12In (1 ± 20%)

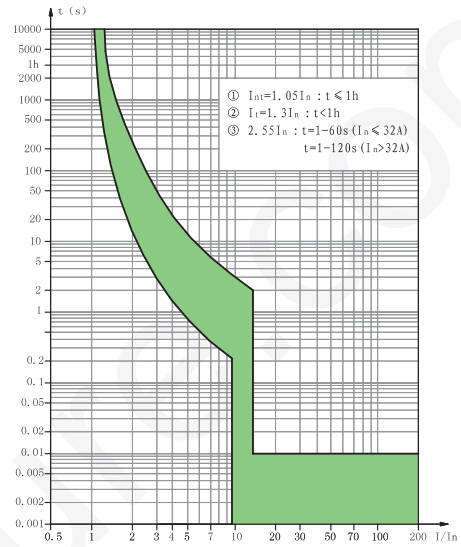

● NDB2ZB-40

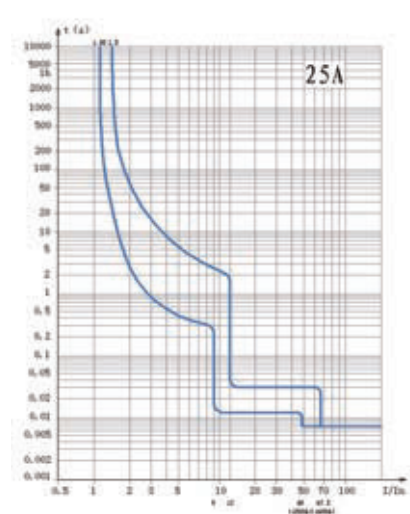
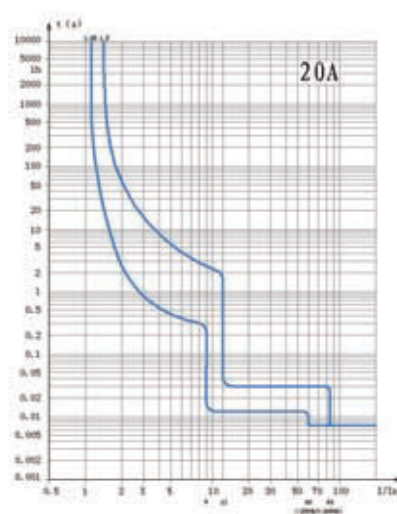
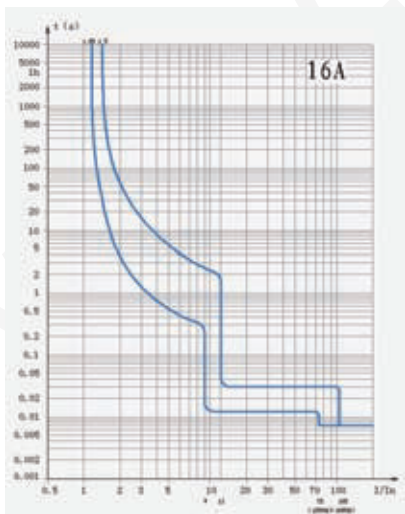

5. Accessories

OF2 auxiliary contact



SD2 alarm contact



MX + OF2 shunt tripper



NDB2Z-63/NDB2Z-63(PV) accessories forms

Serial No.	Name	Accessory code	Function and number of loading
1	Auxiliary contact	OF2	Loaded on the left side of a circuit breaker to indicate the On/Off state of the circuit breaker; 3 can be loaded at most
2	Alarm contact	SD2	Loaded on the left side of a circuit breaker to indicate the fault tripping state of the circuit breaker; 3 can be loaded at most
3	Shunt tripper	MX+OF2	Loaded on the left side of a circuit breaker to indicate the fault tripping state and remote breaking control of the circuit breaker;

Note: For details of accessory parameters, see "OF2, SD2 and MX+OF2" samples

6. Outline and Installation Dimension

6.1 NDB2Z-63 Outline Dimension

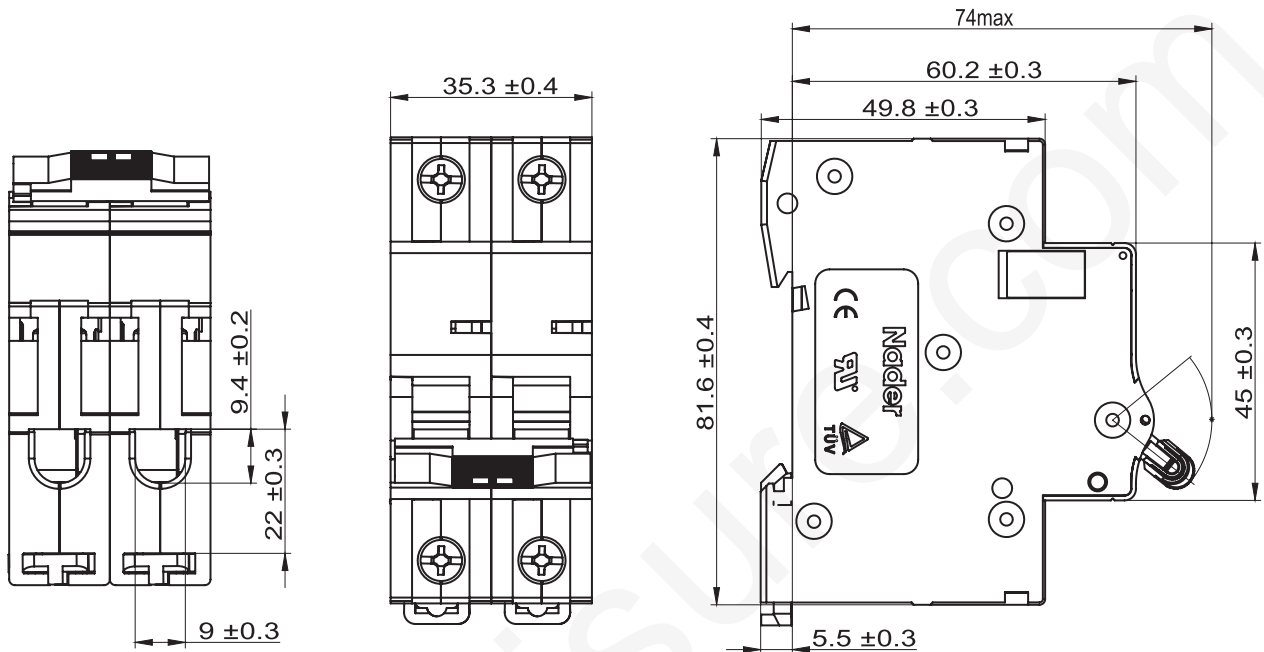

6.2 NDB2Z-63 (PV) Outline Dimension

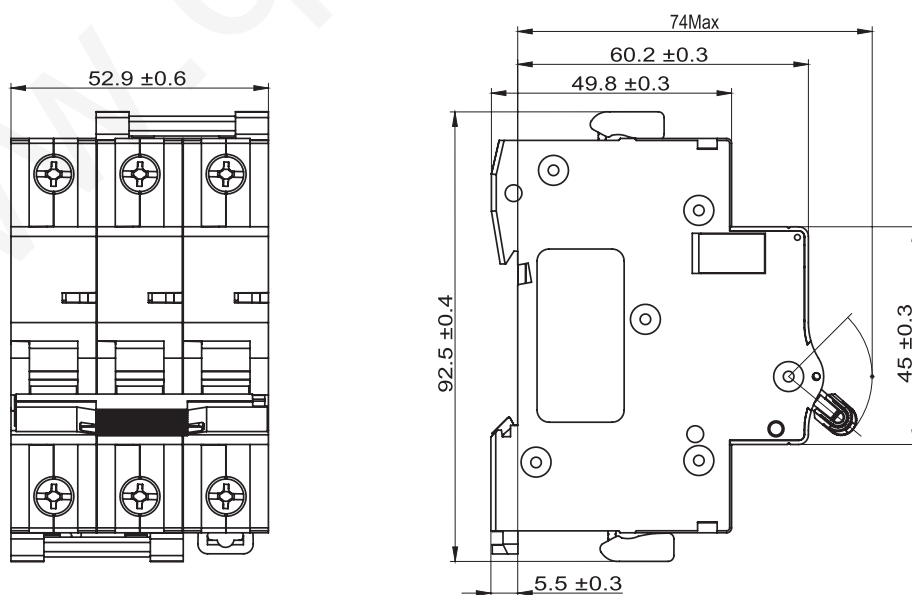

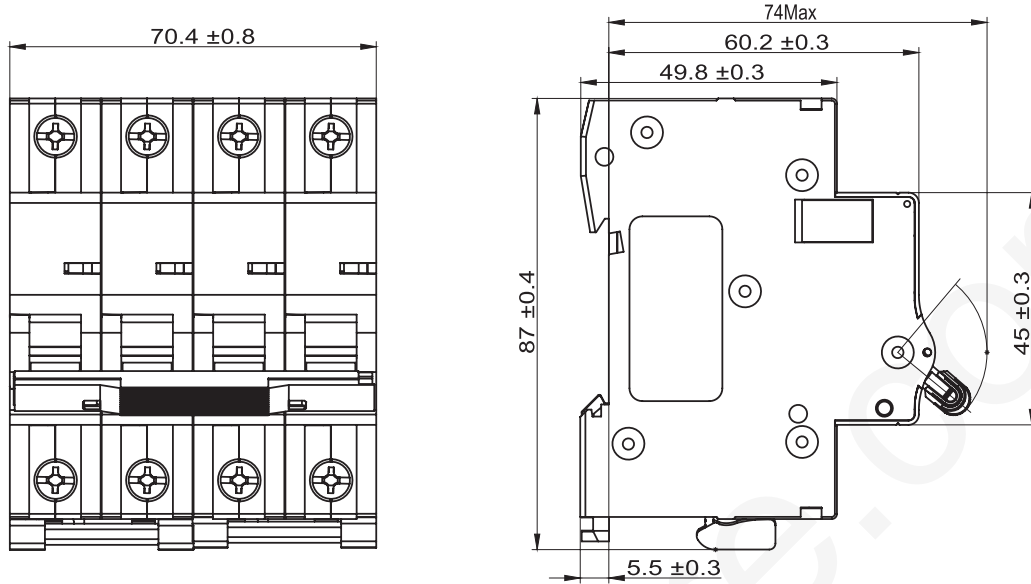

4P

6.3 NDB2ZB-40 Outline Dimension

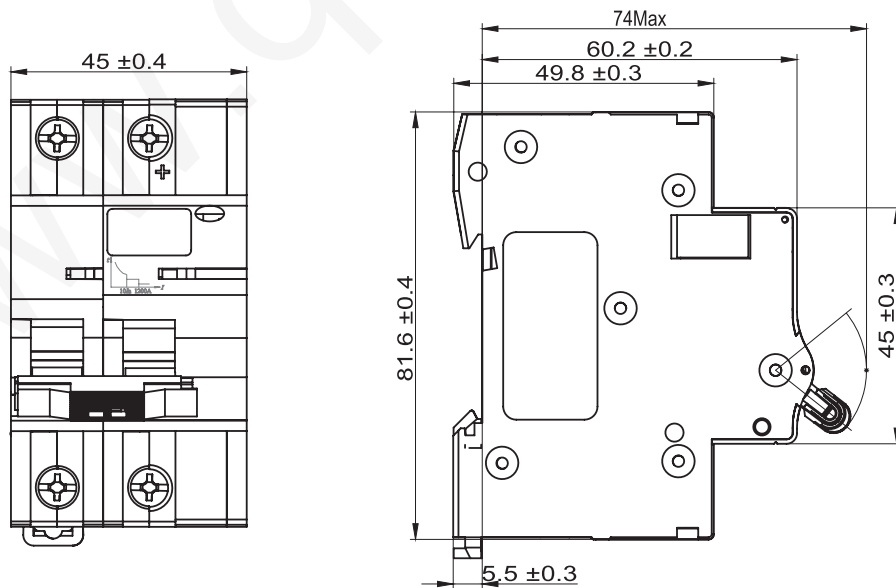

7. Electric Circuit Diagram

● NDB2Z-63

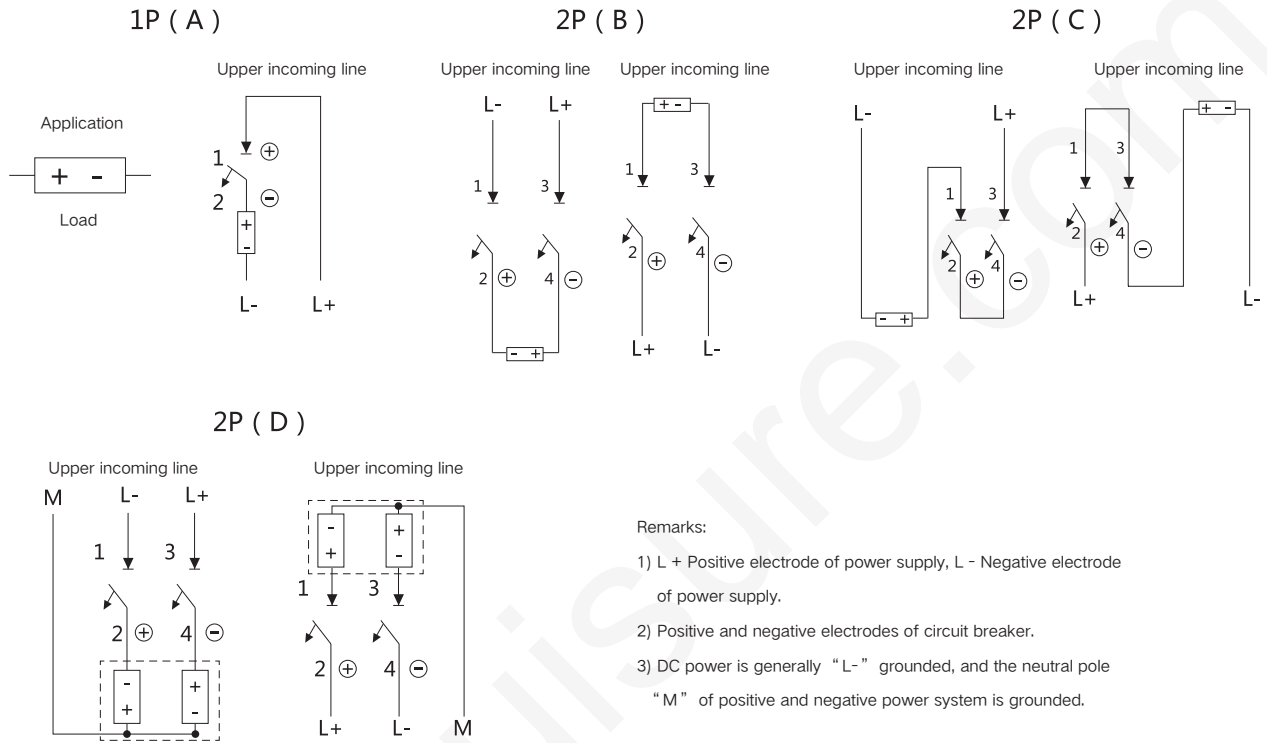

● NDB2Z-63(PV)

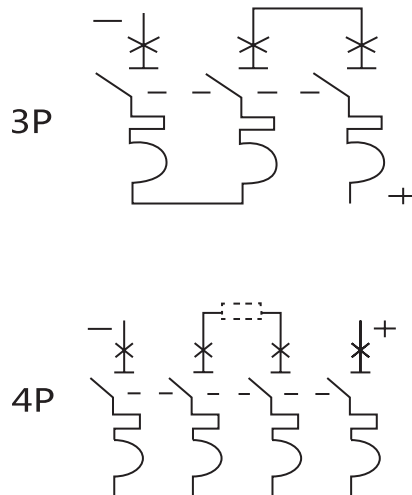

- NDB2ZB-40

