

Product Specifications

Products Name: RCBO

Products model: NDB6LM-40

Date: 20131225

Prepare	Review	Approvel
Na Yang	Min Dong	Haichuang An

Doc. Code	NDT500546	Version	0	Issue Date	20131225
-----------	-----------	---------	---	------------	----------

1. Applicable scope and purpose

- Short -circuit protection
- Over-load protection
- Control
- Isolation
- earth leakage (prevent 5kA lightning time-delay type)

NDB6LM-40 series products is also wildly used in industry,commercial,high-rise and residential building,etc.

2. Picture



3. Model and implication:

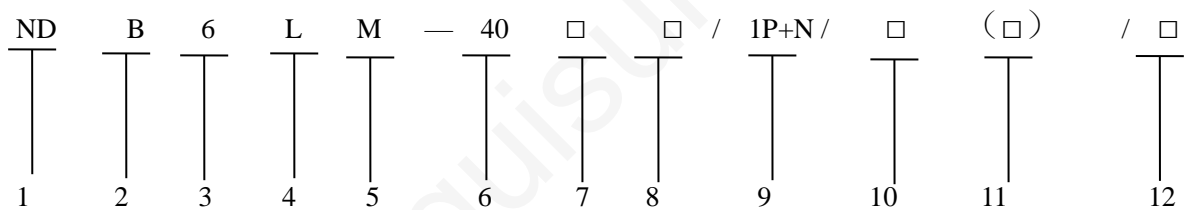

No.	Implication	NDB6LM-40
1	Brand code	ND(Nader)
2	Product code	B
3	Design code	6
4	Earth leakage protection	L
5	Electromagnetic type	M
6	Frame rating(A)	40
7	Instantaneous tripping characteristic	B,C
8	Rated current(A)	6,10,16,20,25,32,40(regular) 25,32,40(with time-delay)
9	Number of poles	1P+N
10	Residual operating current (A)	0.03,0.1,0.3(regular) 0.1,0.3(with time-delay)
11	Regular / with Time-delay	Blank / S
12	Residual operating current type	AC,A

Doc. Code	NDT500546	Version	0	Issue Date	20131225
-----------	-----------	---------	---	------------	----------

4. Main technical specification

- electric parameter
 - Rated working voltage:AC230V;
 - Rated current:6A,10A,16A,20A,25A,32A,40A(regular);
25A,32A,40A(with time-delay);
 - Rated residual operating current:0.03A,0.1A,0.3A(regular);
0.1A,0.3A(with time-delay);
 - Residual operating current type:A,AC;
 - Rated breaking capacity:10kA;
 - Rated residual making and breaking capacity:3kA.
- Isolation function
 - Practical breaking instructions;
 - View window within the green identification said contact in the off position.
- Mechanical life: 20000 times;
- Wiring: Tunnel type terminal
 - Conducting wire:1mm²~25mm² ;
 - Thickness of bus-bar:0.8mm~2mm;
 - Nominal diameter screw:5mm;
 - Tighten screw torque:1.5N.m~2.5N.m.
- Wiring Diagram

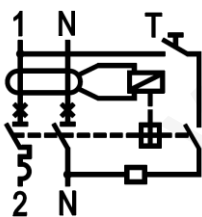

5. Normal working environment

- ambient temperature:-25°C~+60°C;
- Air relative humidity:≤95%;
- height:≤2000m;
- pollution degree:2;
- External magnetic field should be 5 times less than geomagnetic field;
- Used in place without significant shock and collision.

Doc. Code	NDT500546	Version	0	Issue Date	20131225
-----------	-----------	---------	---	------------	----------

6. Tripping characteristic

● B type curve

- Protection of short circuit current small load (Such as non-inductive or micro-sense circuit);
- rated current: 6A, 10A, 16A, 20A, 25A, 32A, 40A;
- tripping characteristic: $3I_n \sim 5I_n$.

● C type curve

- Protect normal load and distribution wire cable;
- rated current: 6A, 10A, 16A, 20A, 25A, 32A, 40A;
- tripping characteristic: $5I_n \sim 10I_n$.

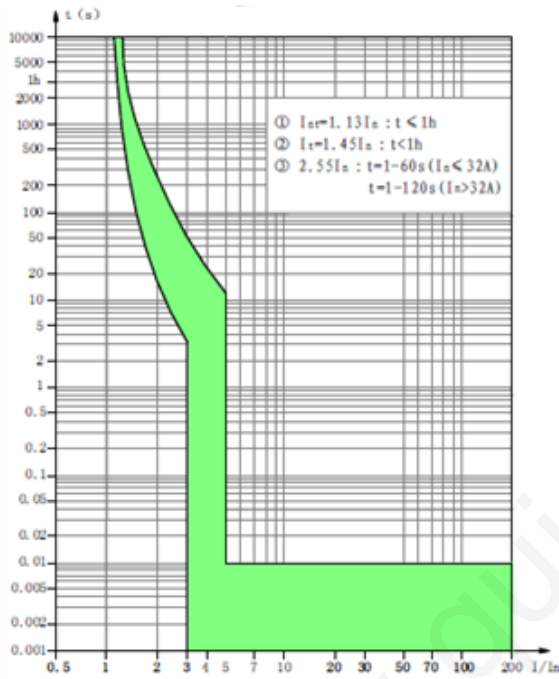

Type B

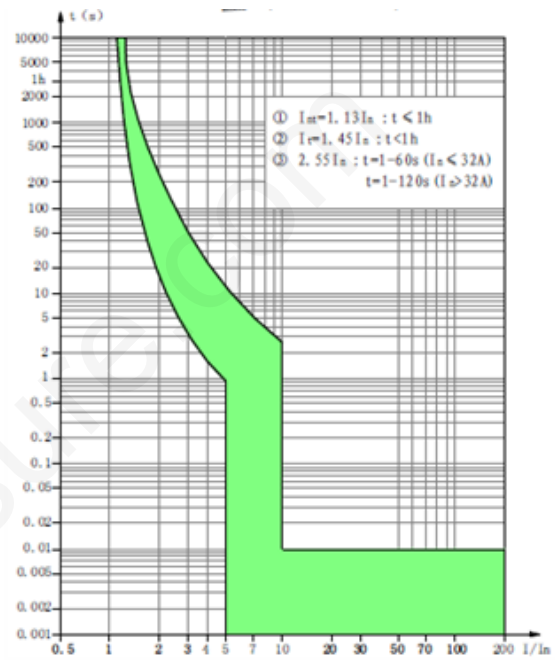

Type C

7. Outline dimensions

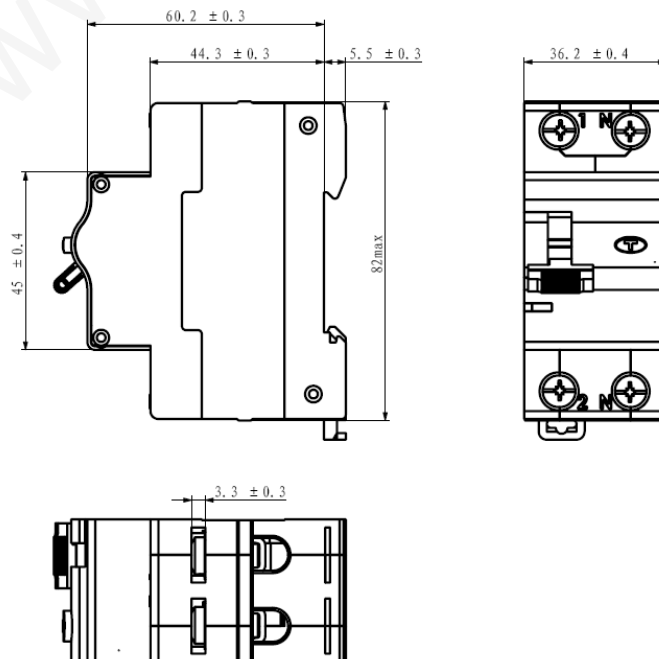

Doc. Code	NDT500546	Version	0	Issue Date	20131225
-----------	-----------	---------	---	------------	----------

8. Mounting

Modular construction,can be installed in TH35mm x 7.5 standard guide rail.

9. Packing storage

Quantity(7PCS/box,6 box/carton),Packing boxes of products should be stored in the air circulation and relative humidity is not more than 80% and the temperature is not higher than + 80 °C, Not less than - 40 °C in the air around without acid, external magnetic field should be 5 times less than geomagnetic field,alkali or other corrosive gases stored in the warehouse. In the above conditions, the storage period since the production date not more than three years.

10. Accessories list and mounting

●NDH1 bus-bar:It is NDB6LM-40 series products modular accessories,suitable for many sets of circuit breaker with phase,Also can be used as a generalization of the dimension accessories used in phase with the electrical terminal.

11. Notice

- No responsibility for problems occurred by disassembly privately;
- RCBO can't provide protection in the cases that touch two phase line synchronously;
- Please don't perform insulating resistance test or voltage-withstand test on the product directly or indirectly by megohmmeter or similar test devices. If you need, we can offer validated proof regarding this item;
- When testing insulating resistance of the engineering circuit, the RCBO should not be connected to avoid misunderstanding on the products' quality or damage to the PCB of products;
- Please make sure reliable connection to avoid fault tripping or damage of terminals caused by exceptional heat resulted from unsuitable connection;
- Simulating test should be made once a month by pressing the test button to check whether the circuit breaker works normally. If RCBO is abnormal, it should be replaced.