



OF, SD, MX+OF, NGQ1A Accessory

2019 Edition

Nader

1. Product Overview

				
Item	OF Auxiliary Contact	SD Alarm Contact	MX+OF Shunt Release	NGQ1A Over-voltage and Under-voltage Accessory
Material Code	30000336	30000347	30000364	30000986
Adaptation	NDM1-63、125 NDM1A-63、125 NDM1T-63 NDM1L-32、50、100 NDM1F-63	NDM1-63、125 NDM1A-63、125 NDM1T-63 NDM1L-32、50、100 NDM1F-63	NDM1-63、125 NDM1A-63、125 NDM1T-63	NDM1-63、125 NDM1A-63、125 NDM1T-63

2. Application Scope

This Series Accessory can be mounted to NDM1 series MCB in circuits with AC50Hz, Rated Voltage below AC230V(include) and below DC125. This series accessory are widely used in the terminal distribution equipment of low-voltage in such fields:Industry, civil building, energy, telecommunication and infrastructure etc.

3. Working Condition

● Mounting Method

TH35mm standard mounting rail

● Mounting Direction

Horizontal Mounting

● Environmental Requirement

Comply with RoHS

4. Product Technical Characteristic

4.1 OF Auxiliary Contact

● Application

Linked to the left side of NDM1 to indicate OPEN or CLOSE status of the associated breaker.

● Application

Rated Working Parameters

	Voltage	Current		Voltage	Current
AC	230V	6A	AC	400V	3A
DC	24V	6A	DC	48V	2A
DC	125V	1A	DC	250V	0.4A

Width(mm): 9

Notes: Connected with NDM1 Series Breaker,
When it is Closing:11,14 means Connecting.
When it is Opening:11,12 means Connecting.
Max.Assemble Quantity:2 Pcs OF or 1 Pcs OF+ 1 Pcs SD.

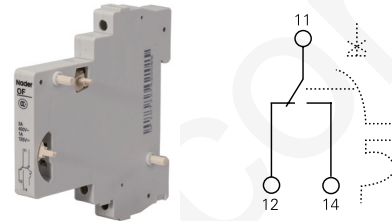

4.2 SD Alarm Contact

● Application

Linked to the left side of NDM1 to indicate the accidental tripping status of the associated breaker.

● Technical Parameters

Rated Working Parameters

	Voltage	Current		Voltage	Current
AC	230V	6A	AC	400V	3A
DC	24V	6A	DC	48V	2A
DC	125V	1A	DC	250V	0.4A

Width(mm): 9

Notes: Connected with NDM1 Series Breaker,
When it is Closing:91,92 means Connecting.
When it is Opening by accidents:91,94 means Connecting.
When it is Opening by hands:91,92 means Connecting;91,94means disconnecting.
Max. Assemble Quantity:2 Pcs SD

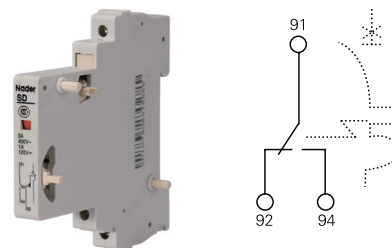

● Wiring Capacity

- ★ Single: 2.5mm² (cables); Double: 1.5mm² (cables)
- ★ Accessory of NDM1 Series MCB can be offered separately, used with other company's MCB is not recommended.

4.3 MX+OF Shunt Release

● Application

Linked to the left side of NDM1 to indicate the accidental tripping status of the associated breaker.

● Technical Parameters

Controlled Voltage: AC 230V/400V DC 24V/48V

Width(mm): 18

Note: The conversion contact should be active contact and the former can't be passive contact to connect the other ELV module.

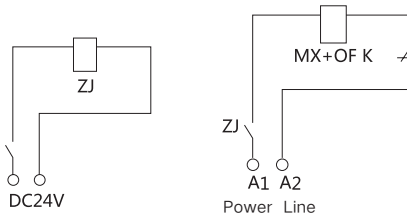
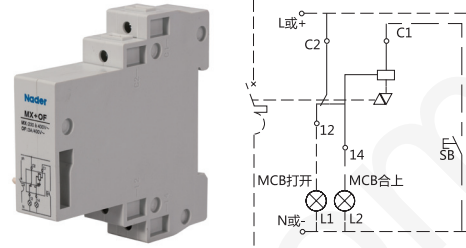

Note: When the voltage of control power circuit is DC24v, we recommend you to take the shunt control loop design as above. ZJ: Represent the middle relay(the contact capacity should be 1A)

● Wiring Capacity

- ★ Single: 2.5mm² (cables); Double: 1.5mm²(cables)
- ★ This accessory can be offered separately, used with other company's MCB is not recommended.

4.4 NGQ1A Over-voltage and Under-voltage Release

● Application

Linked to the right side of NDM1-63 to realize the protection function of single-phase over-voltage, under-voltage, over-voltage and under-voltage.

● Technical Parameters

- ★ Rated Over-voltage operation value (U_{over}) : AC280V ± 5% ,
Max. Breaking Time: 0.2S
- ★ Rated Under-voltage operation value (U_{under})U_{under} : AC170V ± 7% ,
Max. Breaking Time: 1S
- ★ Width(mm): 18

Note: User can select over-voltage release or under-voltage release depend on their need.

Every circuit breaker only matched with 1Pcs over-voltage release to realize the single path protection.

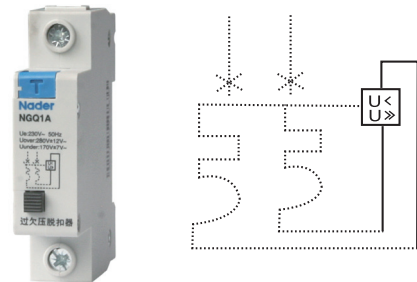

5. Outline and Mounting Dimension (mm)

5.1 OF、SD External Dimension

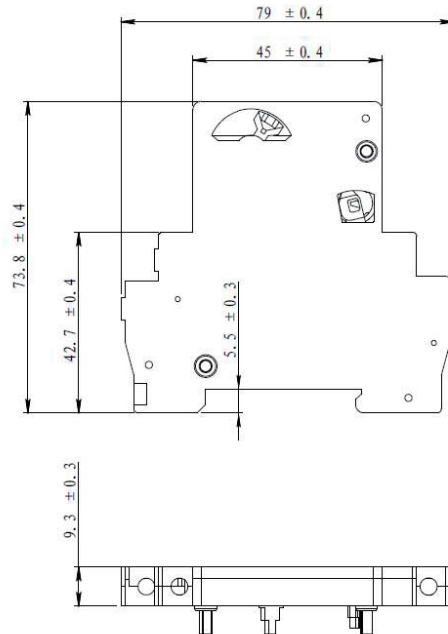

5.2 MX+OF External Dimension

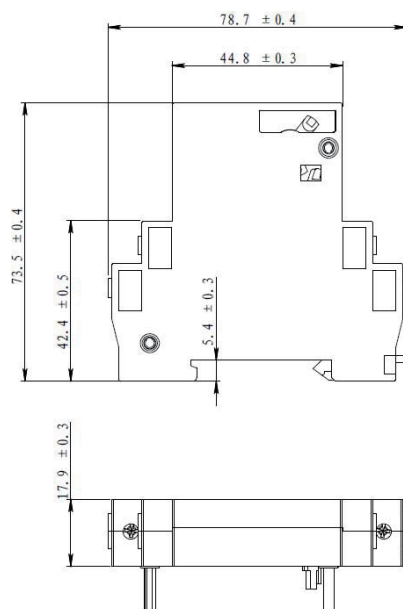

5.3 NGQ1A External Dimension

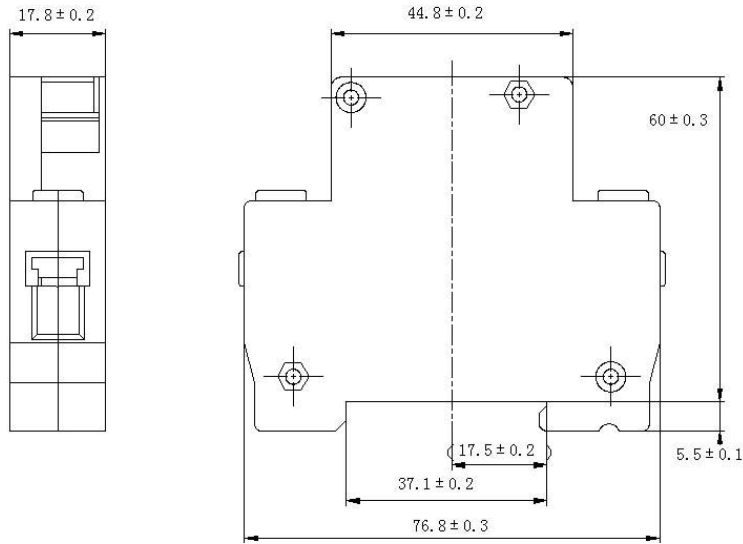

6. Wiring Diagram

