

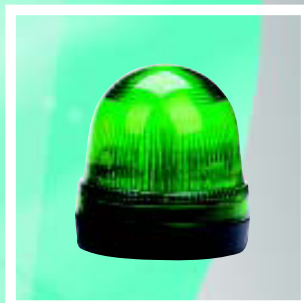

**2014-2015**

# **SIGNAL TOWER**

**JD36,JD50,JD70,  
JD90,JD150**

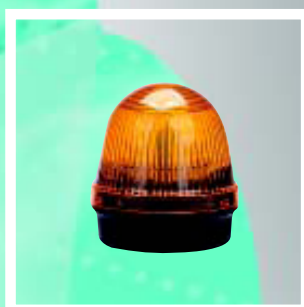

**TAYEE**

# SIGNAL LAMP



## APPEARANCE

The Europe traditional design style is steady and in good taste, showing originality, endowing your equipment with innervation and vitality, upgrading the appearance and function, making your products coruscate.

## MATERIAL

The JD-series signal lamps are covered with high-quality materials which has vivid color and good transmissivity and no fading after long time use.

## DEGREE OF PROTECTION - IP65

In order to make the products widely used in every walk of life, TAYEE follows its consistent high standard during the process of design and manufacture, which makes every product's degree of protection meet IP65 and satisfy your needs.

## INDIVIDUATION OPTION

More and more innovation is required in this competitive age. The JD-series signal lamps supply different kinds of appearance for you, such as JD50A, JD50CA, JD70CA, JD70A, JD90B, JD150A, JD150B which can give you individuation production.

## VARIETY

The JD-series signal lamps can be divided into 50mm-JD50, 70mm-JD70, 90mm-JD90, 150mm-JD150 according to diameter and be divided into single light style and optical-audible style according to function.

# SIGNAL TOWER



*Rational design*

*exquisite art and craft (technics)*

## Perfection shape

JD70 series caution system adopt Europe style , The excellence performance and generous shape design, undoubted this is your best choice.

## High quality material

JD70 series caution system adopt high quality material, clear colour and luster; good diaphaneity; realizing show the signal. Fastness, attrite, using for a long time

## Building block assemble

JD70 series caution system's building block assemble is easy to knock down, erector and inspector

## Whole photoelectric system

JD70 series caution system would make the light system and electric system unity perfection. Not only reduce the system's height (It is about 30%) and let the swrfaceman easy to maitain the product each tier. reduce the repuiring cost.

## Free assemble

Difference Combination way express kinds of function. JD70 series caution system can Combine with customer's request .



## Protection degree ---IP65

In the design process, we consider of all kinds of customer's request ,JD70 series caution system can suitable all of the environment . protection degree are IP65. The application are not limited .



# Ø70 SIGNAL TOWER

## PERFORMANCE CHARACTERISTIC

### Optical source type

JD701 optical element has offered many kinds of optical source for customers - LED, superbright LED, filament lamp, xenon lamp. Compared with common LED, the superbright LED has a 3-time luminance and its service time was prolonged greatly. It can work for 100,000 hours normally and there is no need for current maintenance. It also has more colors to choose, such as white, pure green and pure blue.

#### LED

4 types of luminescence modes  
permanent  
blink  
rotating flash  
adjustable  
(between permanent and blink)



#### SUPERBRIGHT LED

4 types of luminescence modes  
permanent  
blink  
rotating flash  
adjustable  
(between permanent and blink)

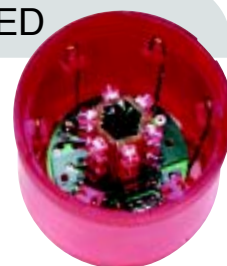

#### FILAMENT LAMP

2 types of luminescence modes  
permanent  
blink



#### XENON LAMP

Only 1 mode  
blink(flash)  
flash frequency  
0.5Hz-2Hz



### AUDIBLE SOURCE TYPE

JD702 voice element have four kinds of voice: buzzer, horn, music and language. It's can suitable for all kinds of environment's request..It is three kinds of decibel: 80db, 105db, 120db.



#### HORN

Only 1 sounding mode  
Continuous  
120dB



#### BUZZER

3 sounding modes  
Continuous  
Intermittent  
Adjustable  
(between continuous and inermittent)



#### MUSIC

4 music modes  
Electronic-mix  
Waltz  
For Alice  
The sweet homes  
\*Individuation music can be ordered

#### LANGUAGE

4 language modes  
Keep Clear - High Voltage  
Breakdown  
Upper Limit  
Be careful - crash  
\* Individualized language can be ordered

## PERFORMANCE AND CHARACTER

### luminescence form

JD701 light element have varies luminescence form: frequent light, frequent flash, Transfer flash, and adjust type signal system able to adjust as you want (frequent light and frequent flash )this structure is Tianyi electric's patent.

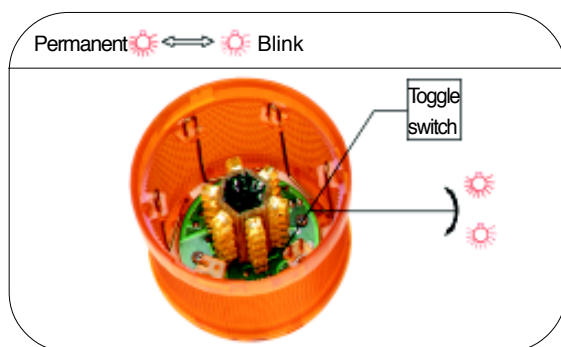

### Voice format

JD701 voice element have three voice form: Interrupt, Continue and adjust type. the adjust type warning system able to adjust as you want (interrupt and continue)this structure is Tianyi electric's patent.

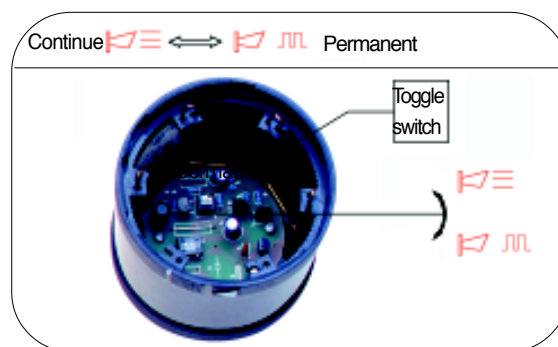

### Install format

Tianyi electric applied kinds of install accessories, you can install JD70 caution system on the side; horizontal and upright; and also you can adjust the height.



### Connection foundation

You can connect JD70 caution system to your machine quickly and simply ,let it exert strong function .



### Strong performance

JD70 caution system have some of alarm function .for example :trouble denote ; await orders denote; repairing denote and trouble alarm .

### Resist vibration

The vibration will have different damage to the element when machine in the working process , and reducing the using life ,JD70 caution system special resist vibration design avoid it ,so it increase product's using life .



## TECHNICAL PARAMETER

### Guideline of Current

| Type                          | 24V          | 220V         |
|-------------------------------|--------------|--------------|
| Filament Lamp maximum current | 3W           | 3W           |
| LED maximum current           | 0.1A/2.4W    | 0.05A/0.8W   |
| Buzzer maximum current        | 0.015A/0.36W | 0.015A/0.45W |
| Xenon lamp maximum current    | 0.2A/4.8W    | 0.03A/6.6W   |
| Xenon Lamp maximum current    | 0.25A/6W     | 0.25A/3.2W   |

### Working Environment

|                           |                     |
|---------------------------|---------------------|
| Environmental Temperature | -25℃ ~ +55℃         |
| Degree of Pollution       | Class 3             |
| Antivibration             | 10-2000Hz, 1mm, 15g |
| Degree of Protection      | IP 65               |
| Installation Type         | III                 |
| Altitude                  | ≤ 2000m             |
| Relative Mositure of Air  | ≤ 98%               |



## ORDER TYPE

### Light element

| JD | 701           | — | Optical source   | + | Luminescence modes | + | Color  | + | Voltage |
|----|---------------|---|------------------|---|--------------------|---|--------|---|---------|
|    | ↓             |   | ↓                |   | ↓                  |   | ↓      |   | ↓       |
|    | Ø70 diameter  |   | LED              |   | Permanent          |   | Red    |   | DC      |
|    | Light element |   | Super Bright LED |   | Blink              |   | Green  |   | 24V     |
|    | Light element |   | Filament Lamp    |   | Rotating flash     |   | Yellow |   | AC      |
|    |               |   | Xenon lamp       |   | Adjustable         |   | White  |   | 220V    |
|    |               |   |                  |   |                    |   | Blue   |   |         |

### Diameter Voice element

| JD | 702           | — | Sonic source | + | Sounding modes | + | Decibel | + | Voltage |
|----|---------------|---|--------------|---|----------------|---|---------|---|---------|
|    | ↓             |   | ↓            |   | ↓              |   | ↓       |   | ↓       |
|    | Ø70 diameter  |   | Buzzer       |   | Continue       |   | 80dB    |   | DC      |
|    | Voice element |   | Horn         |   | Interrupt      |   | 100dB   |   | 24V     |
|    |               |   | Music        |   | Adjustable     |   | 120dB   |   | AC      |
|    |               |   | Language     |   |                |   |         |   | 220V    |

## Production type

JD701- order type1+ order type2+ order type3+ order type4





|   | Optical source   |             | Luminescence modes                                 |                      | Color                                   |                       | Voltage                     |                |
|---|------------------|-------------|--|----------------------|---|-----------------------|-----------------------------|----------------|
|   | Optical source   | Order type1 | Modes  | Order type2          | Color                                   | Order type3           | Voltage                     | Order type4    |
|   | LED              | L           | Permanent<br>Blink<br>Rotating flash<br>Adjustable | 01<br>02<br>03<br>04 | Red<br>Green<br>Yellow<br>White<br>Blue | R<br>G<br>Y<br>W<br>S | DC<br>24V                   | 024            |
|  | Super Bright LED | H           | Permanent<br>Blink<br>Rotating flash<br>Adjustable | 01<br>02<br>03<br>04 | Red<br>Green<br>Yellow<br>White<br>Blue | R<br>G<br>Y<br>W<br>S | AC<br>220V                  | 122            |
|  | Xenon lamp       | S           | Blink  | 02                   | Red<br>Green<br>Yellow<br>White<br>Blue | R<br>G<br>Y<br>W<br>S | DC<br>24V<br><br>AC<br>220V | 024<br><br>122 |
|  | Filament Lamp    | X           | Permanent<br>Blink                                 | 01<br>02             | Red<br>Green<br>Yellow<br>White<br>Blue | R<br>G<br>Y<br>W<br>S | DC<br>24V<br><br>AC<br>220V | 024<br><br>122 |

Note:DC is applicable to AC (which means DC and AC are both applicable). Special voltage can be ordered.





## Production type

JD702- order type1+ order type2+ order type3+ order type4+ order type5

|   | Sonic source |             | Sounding modes  |  | Decibel       |             | Color |             | Voltage                     |                    |
|---|--------------|-------------|---|--|---------------|-------------|-------|-------------|-----------------------------|--------------------|
|   | Sound        | Order type1 | Modes   | Order type2                                      | Decibel       | Order type3 | Color | Order type4 | Voltage                     | Order type5        |
|   | Horn         | P           | Continue  | 01   | 120dB         | 12          | Black | B           | DC<br>24V<br><br>AC<br>220V | 024<br><br><br>122 |
|  | Buzzer       | F           | Continue<br>Interrupt<br>Adjust type  | 01<br>02<br>03                                   | 80dB<br>100dB | 08<br>10    | Black | B           |                             |                    |
|  | Music        | M           | Audio mixing<br>Waltzes<br>For Elise<br>The sweet homes                                     | <b>01</b><br><b>04</b><br><b>05</b><br><b>06</b> | 100dB         | 10          | Black | B           |                             |                    |
|  | Language     | V           | Keep Clear -<br>High Voltage<br><br>Breakdown<br><br>Upper Limit<br><br>Be careful<br>crash | 01<br><br>02<br><br>03<br><br>04                 | 100dB         | 10          | Black | B           |                             |                    |

Note:DC is applicable to AC (which means DC and AC are both applicable). Special voltage can be ordered.

# Production type

|  | Name                  | Type |
|---|-----------------------|------|
|   | Decorate cap          | A01  |
|  | Connection foundation | B01  |

## SKETCH MAP FOR MAKEING UP PRODUCT AND ITS ACCESSORIES

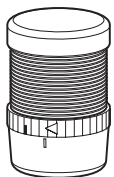

+

JD70 SIGNAL TOWER

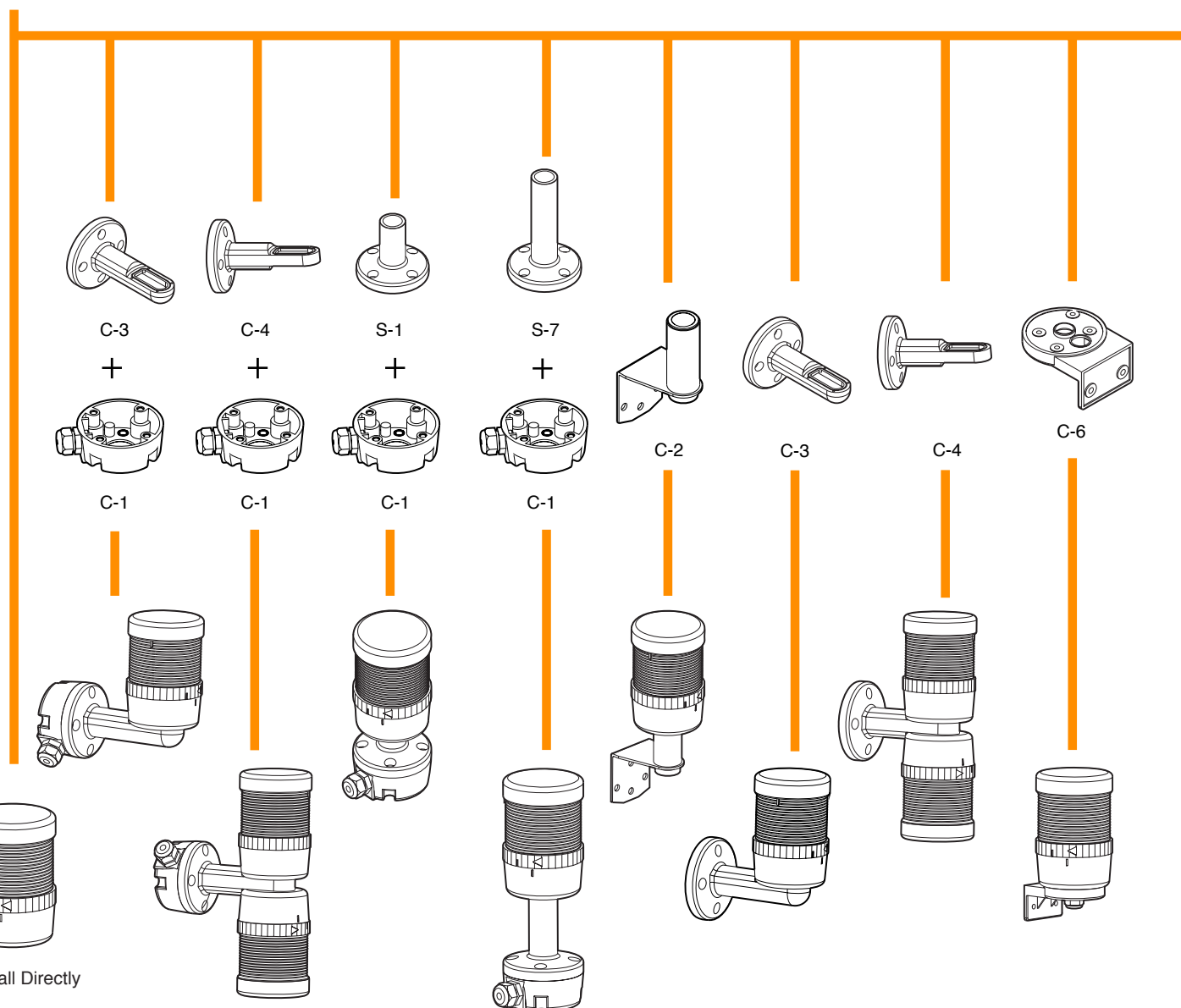

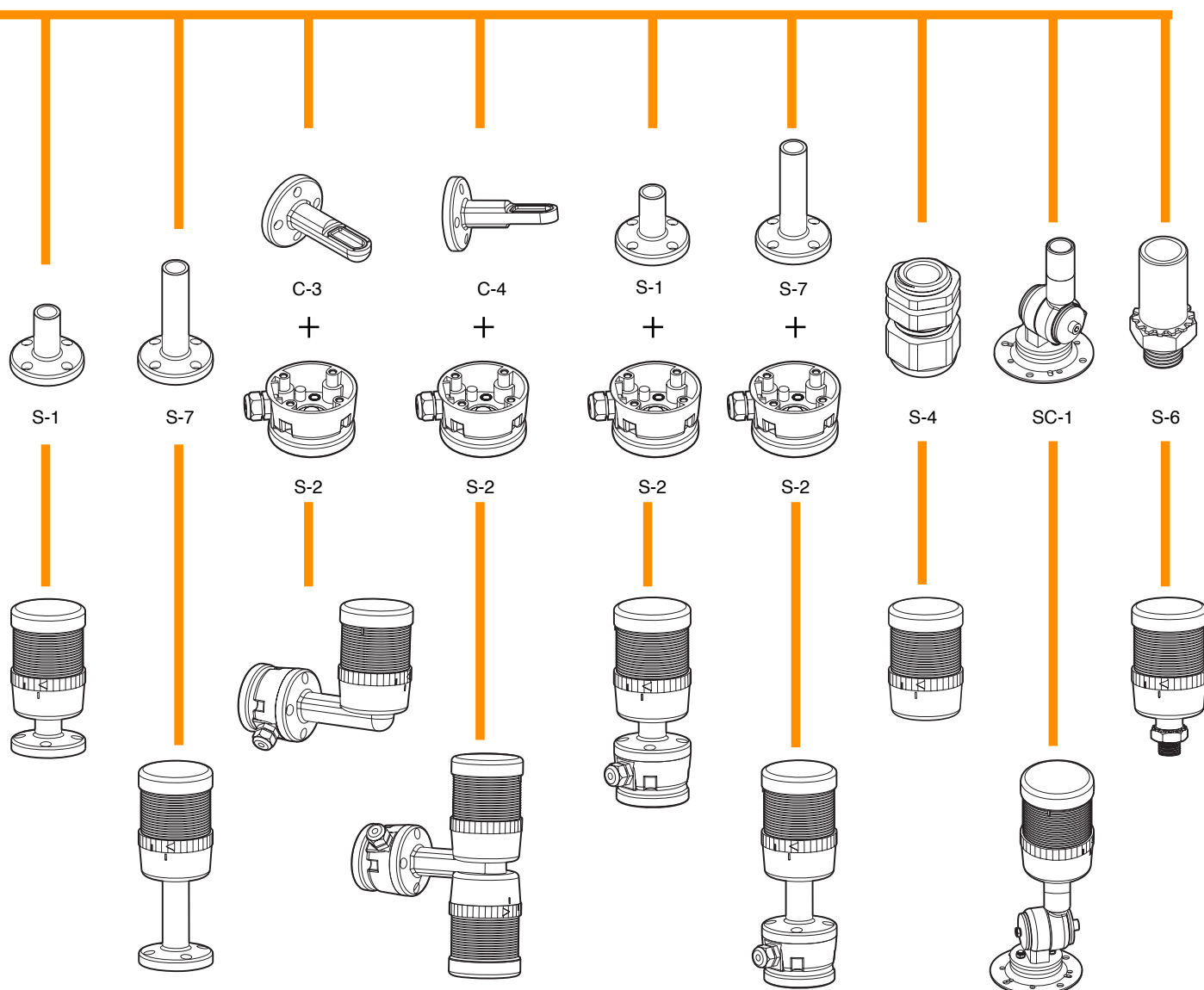

Note: the bottom of S-2 use permanent magnet material (magnet)

Note: SC-1 is collapsible

# SKETCH MAP FOR MAKEING UP PRODUCT AND ITS ACCESSORIES

## To Install Base (out-line) C-1

- ★ It should be used with C-3 or C-4 when sidemounting
- ★ It should be used with S-1 or S-7 when installing vertically

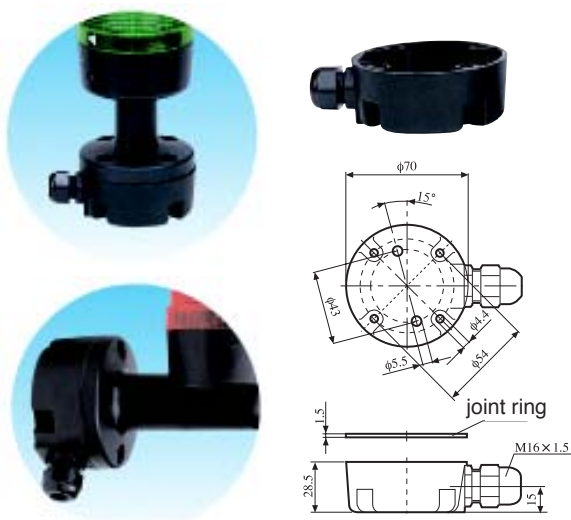

## To Sidemount Base (out-line) C-2

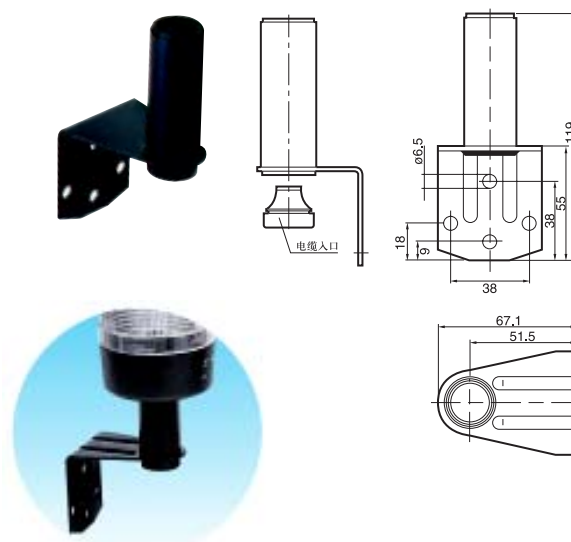

## To Sidemount Base (in-line) C-3

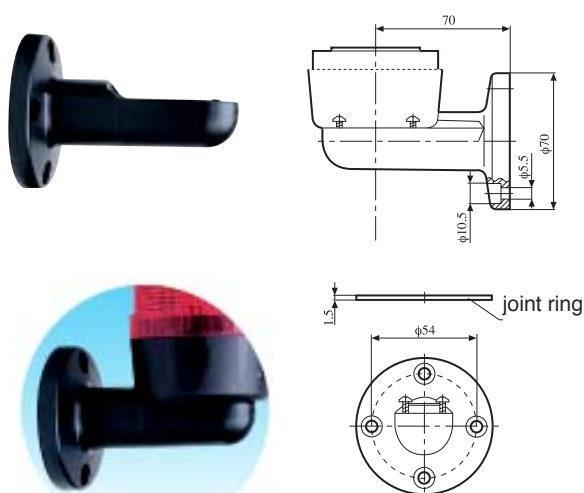

## To Sidemount Base (in-line) C-4

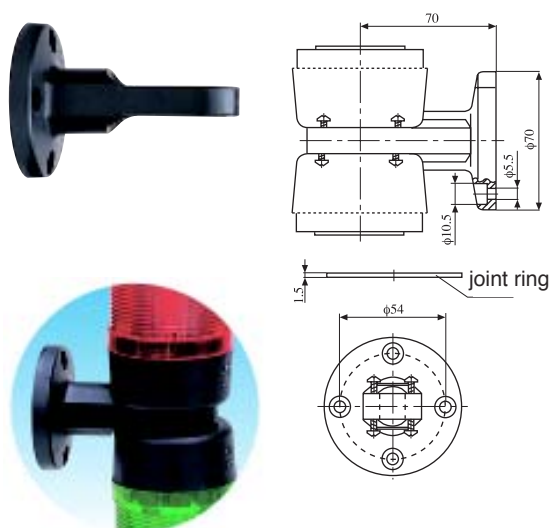

Note:Accessory should be ordered separately.

## SKETCH MAP FOR MAKEING UP PRODUCT AND ITS ACCESSORIES

To Install Base Collapsibly (in-line) SC-1

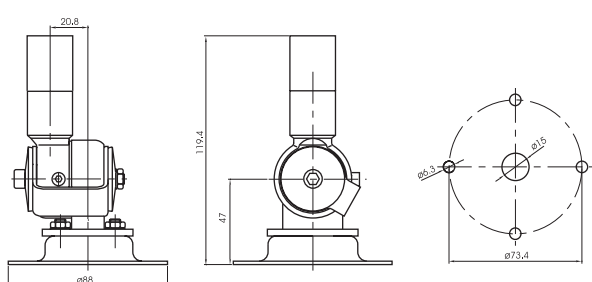

To Sidemount Base (out-line) C-6

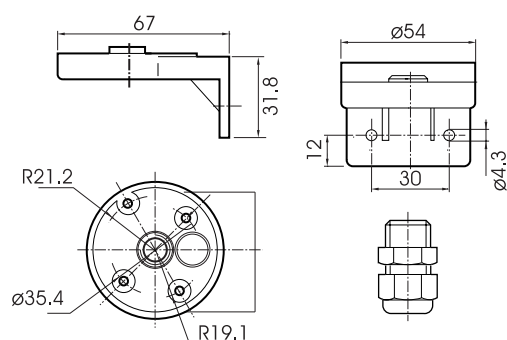

To Install Base Vertically (out-line) S-1,S-7

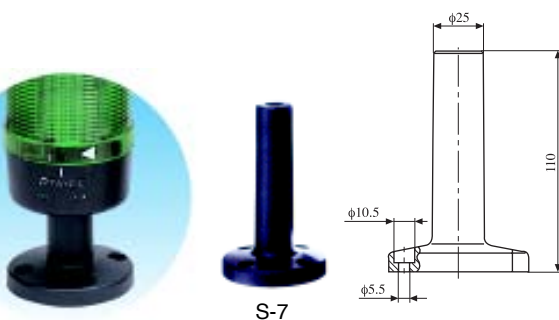
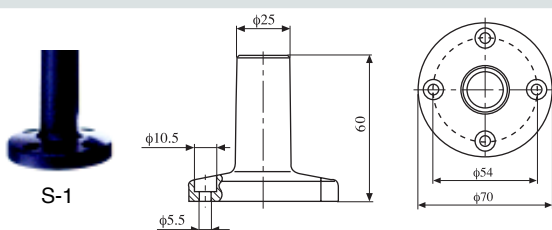

To Install Base Vertically (out-line) S-2

- ★ It should be used with C-3 or C-4 when sidemounting
- ★ It should be used with S-1 or S-7 when vertically mounting
- ★ There is permanent magnet material on the base (magnet steel)(for convenient carriage)

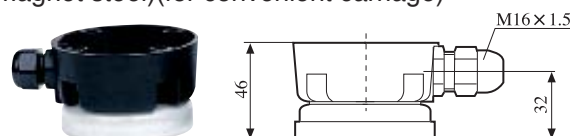



# SKETCH MAP FOR MAKEING UP PRODUCT AND ITS ACCESSORIES

## To Install Cable Joint (in-line) S-4

★ Including B01

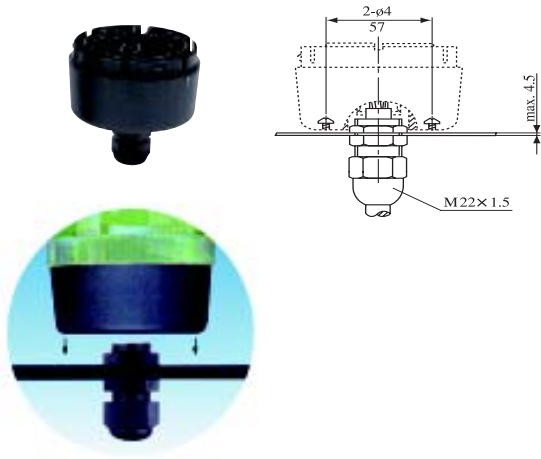

## Connecting Tube

★ It should be used with S-1 or S-7



|       |    |
|-------|----|
| 100mm | G1 |
| 250mm | G2 |
| 400mm | G4 |
| 800mm | G8 |

## To Install the Joint (in-line) S-6

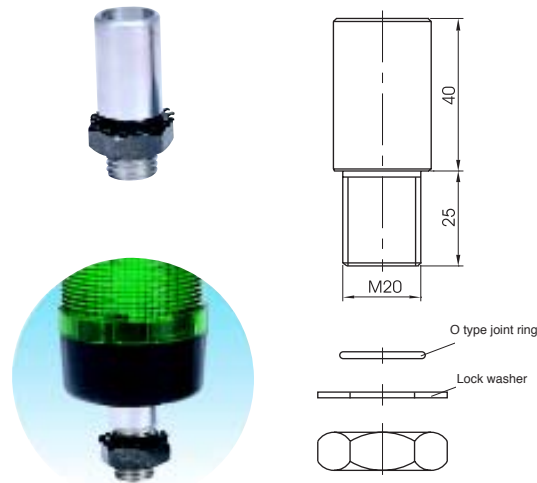

## DEMONSTRATION OF PRODUCT

### 1 Layer



- Cap  
**A01**
- Optical Element  
(Red DC24V LED Blink)  
**JD701-L02R024**
- Connection Base  
**B01**
- Directly Installed Base  
**S-1**

### 2 Layers



- Cap  
**A01**
- Audible Element  
(80dB DC24V Intermittent Singing)  
**JD702-F0208B024**
- Optical Element  
(Yellow DC24V LED Blink)  
**JD701-L02Y024**
- Connection Base  
**B01**
- Directly Installed Base  
**S-1**

### 4 Layers



- Cap  
**A01**
- Audible Element  
(80dB AC220V Continuous Singing)  
**JD702-F0108B122**
- Optical Element  
Green AC220V Superbright LED Permanent  
**JD701-H01G122**
- Optical Element  
White AC220V Superbright LED Permanent  
**JD701-H01W122**
- Optical Element  
Blue AC220V Superbright LED Permanent  
**JD701-H01S122**
- Connection Base  
**B01**
- Directly Installed Base  
**S-1**

### 3 Layers



- Cap  
**A01**
- Optical Element  
Red DC24V Filament Lamp Adjustable  
**JD701-X04R024**
- Optical Element  
Yellow DC24V Filament Lamp Adjustable  
**JD701-X04Y024**
- Optical Element  
Green DC24V Filament Lamp Adjustable  
**JD701-X04G024**
- Connection Base  
**B01**
- Directly Installed Base  
**S-1**

## FULL INSTRUCTION OF INSTALLATION

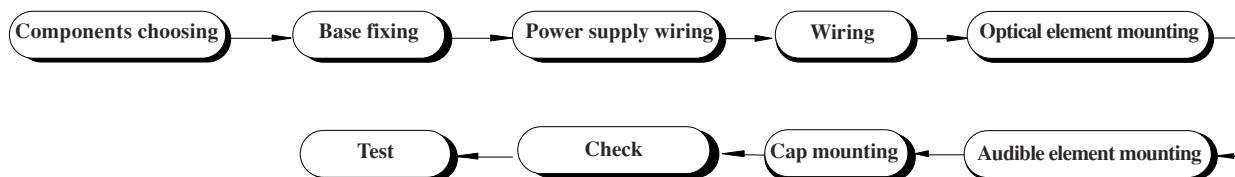

### Demonstration for Conductivity Base Connection

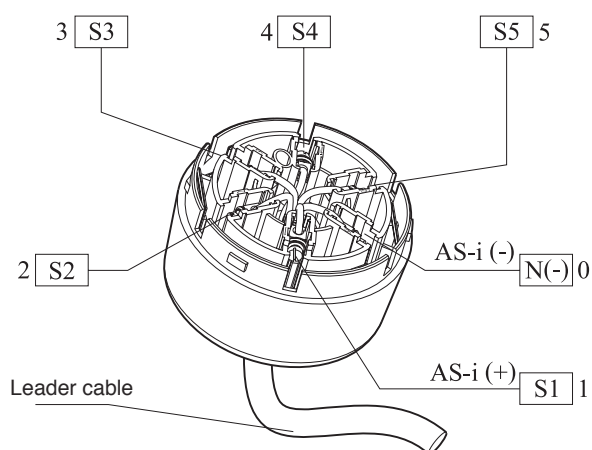

### Demonstration for Installation

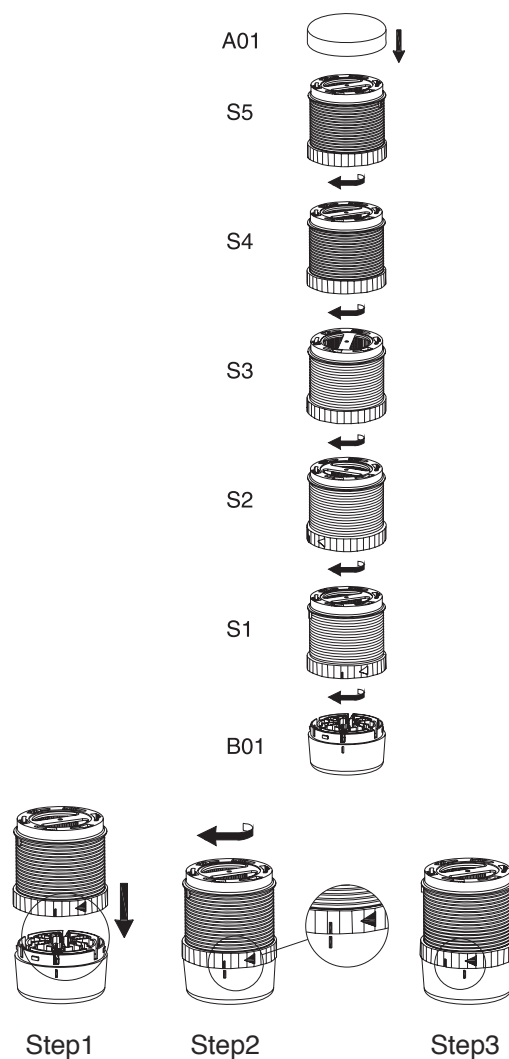

## DIMENSIONAL DRAWING

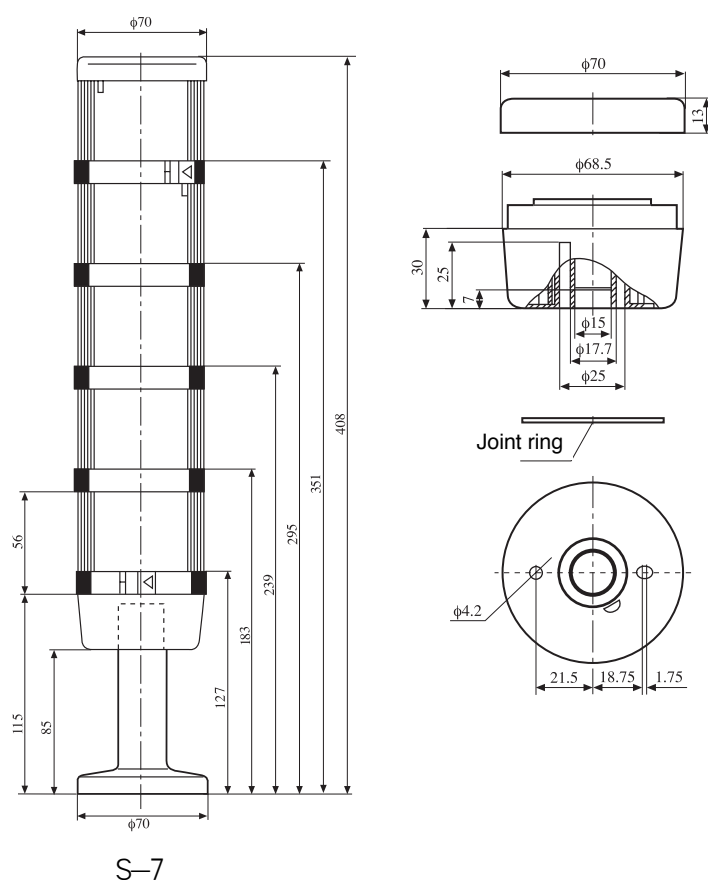

Note: Each dimension decrease 50 when you choose S-1



Matters need attention

**In order to prevent accidents such as fire, electric shock from occurring, users must pay attention on the following precautions:**

- Power must be cut off before installation, construction and inspection.
- Naked light must not exit in the allocated range of this product. Working environmental temperature must be lower than 55°C.
- The cable must reach the safely-using standard.
- Installation foundation and installation line must be firm and steady.
- The installing, maintaining of this product must be operated by professional personnel.

**The product can be installed with different parts by users of their own, but each part must be in the same voltage gradation.**

- Voltage of the power must accord with the stipulated voltage of the products.
- Please wire according to the regulation of the manual when constructing and inspecting.

**In order to keep the caution light striking, please pay attention to the following several points:**

- The outer cover should use the soft cloth to clean frequently, in case the dust hides the light dirtily.
- Avoid contacting the chemical solvent as much as possible, in case that the surface is causticized and fluffed, and influence the transmissivity.
- Put to earth, in case that static damages the device.